

Zodpovědný projektant	Vypracoval		
Jan Šára, Dis.	Jan Šára, Dis.		
Objednatel: Město Český Krumlov			
Místo: tř. Míru - nádraží - Český Krumlov, kraj Jihočeský			
Akce: Chodník a autobusová zastávka Třída Míru - nádraží - Český Krumlov		Č. Zakázky:	05-2015
		Datum:	únor 2015
		Formát:	
		Měřítko:	1 : 100
Část:		Stupeň:	DSP / PDS
Výkres: PŘÍČNÉ ŘEZY		Č. Přílohy: 7.	Souprava:

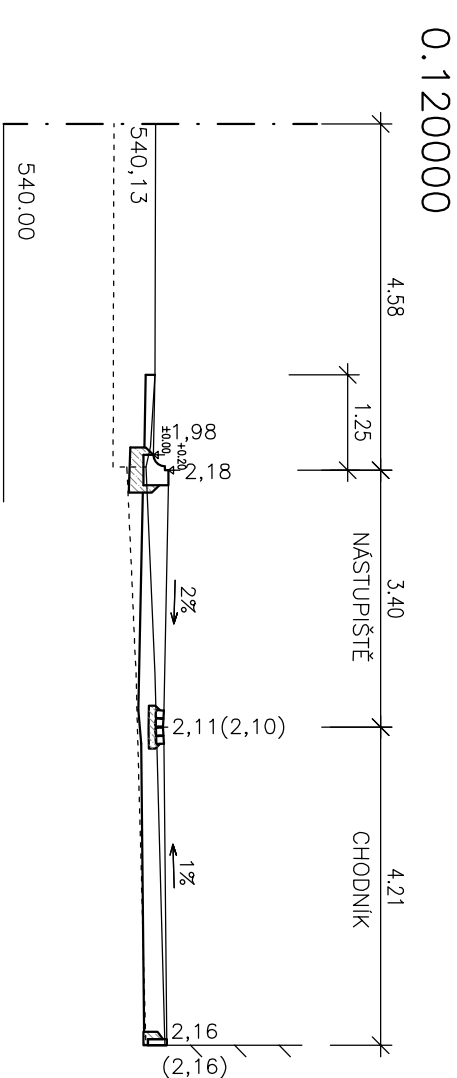

0.130000

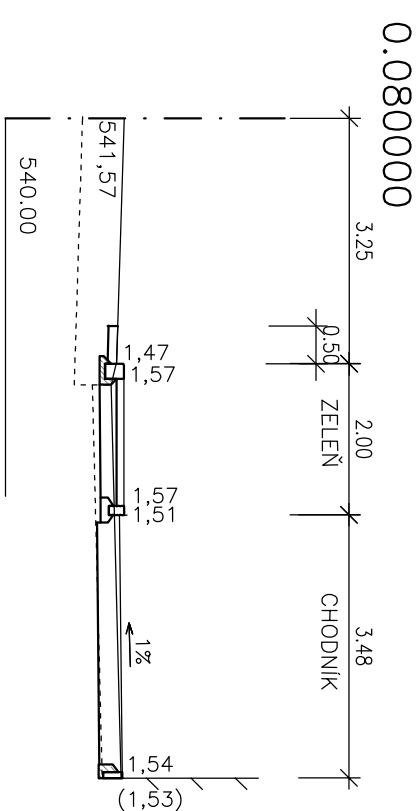
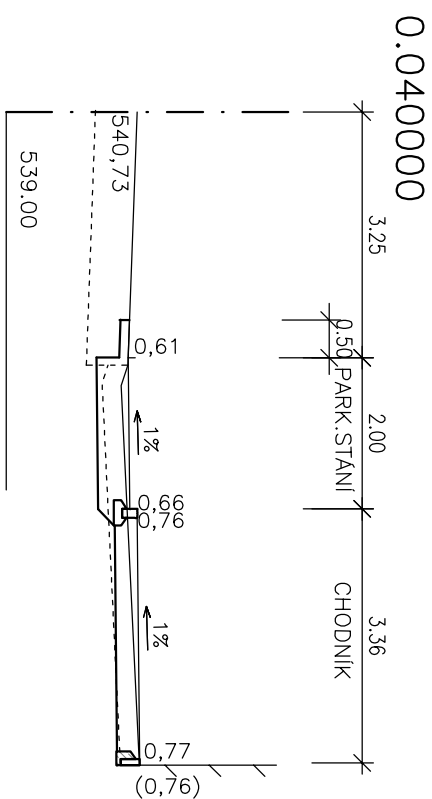
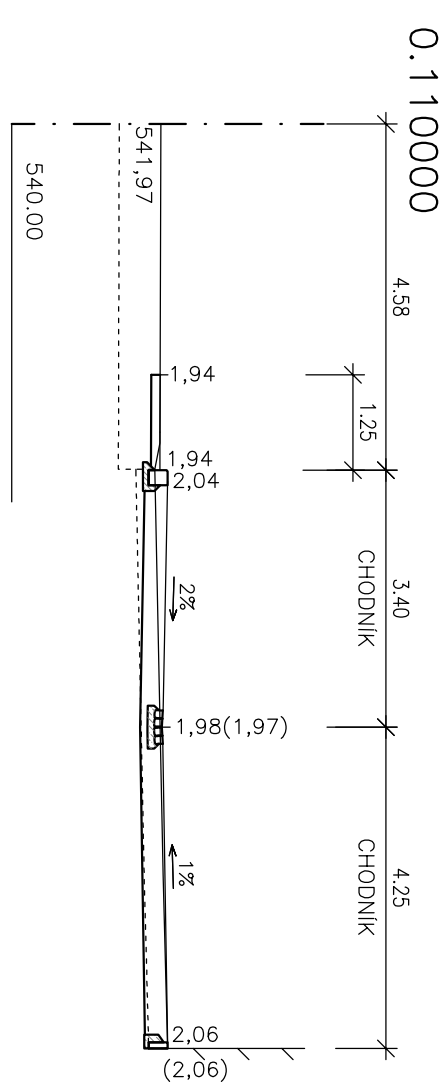
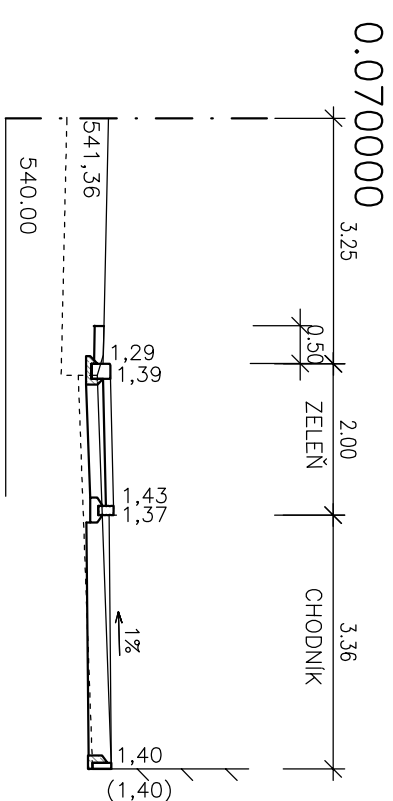
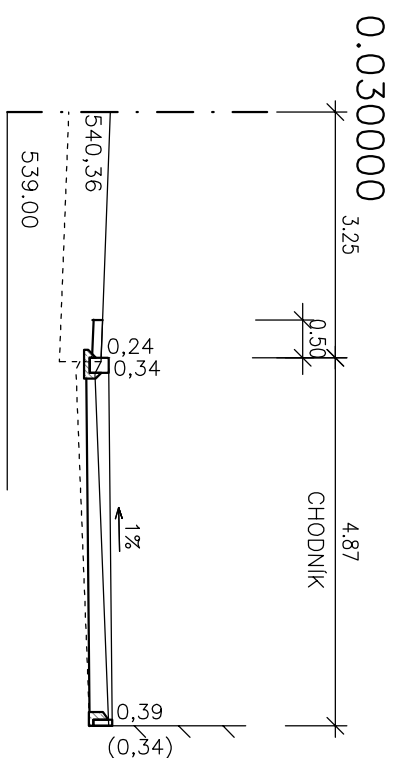
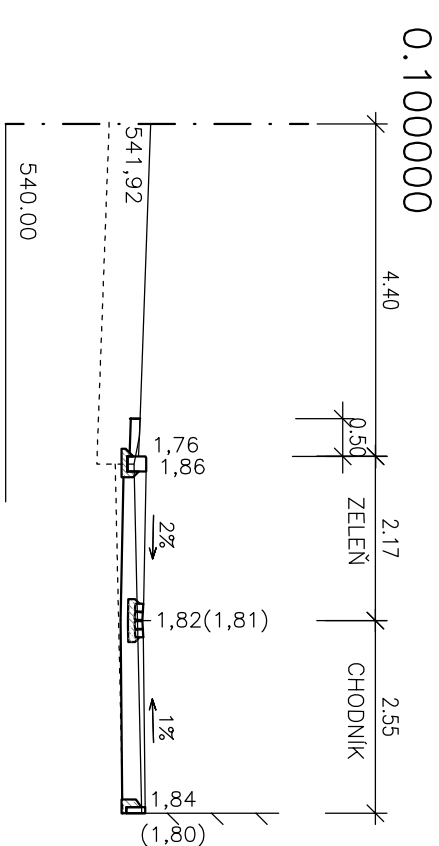
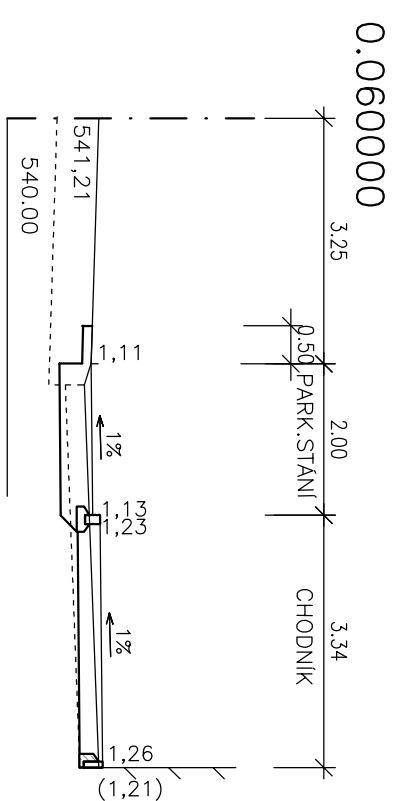
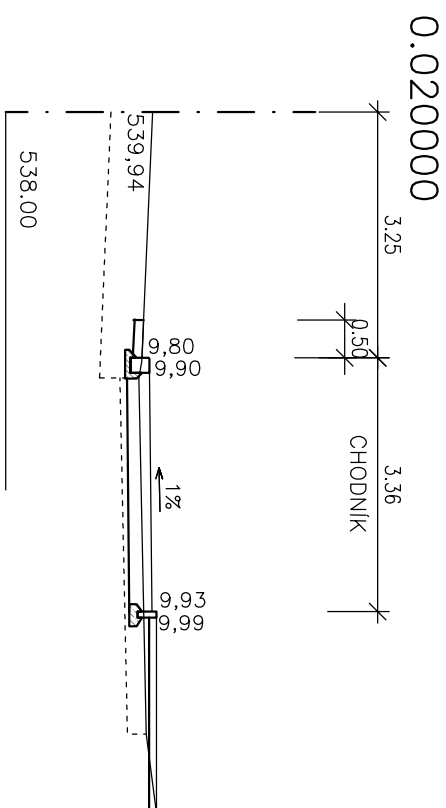
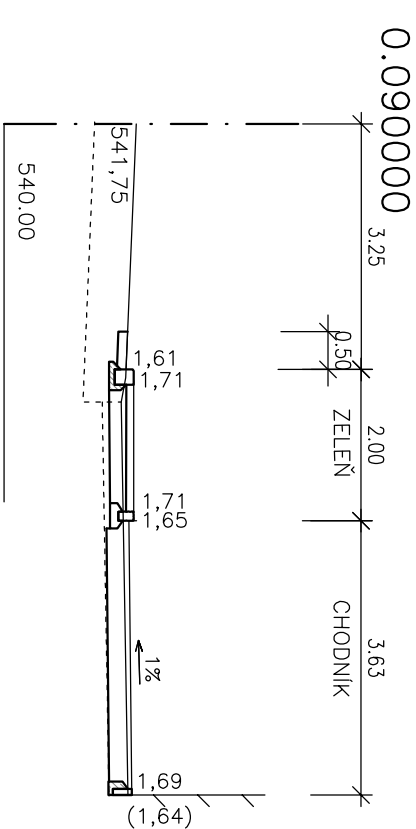
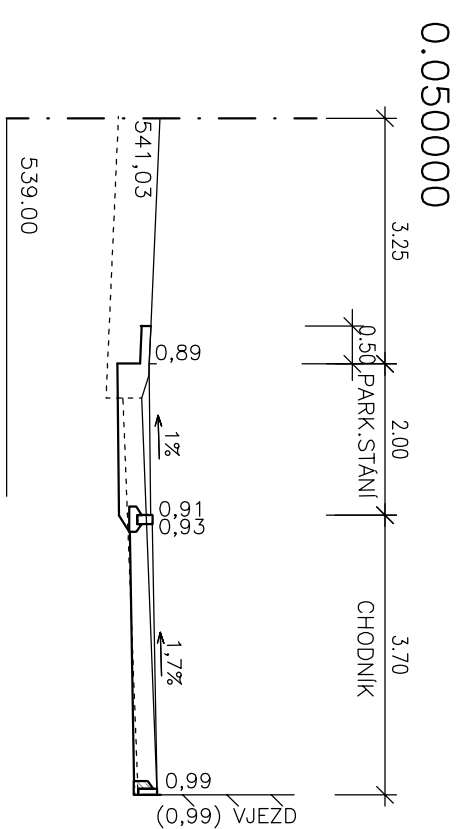
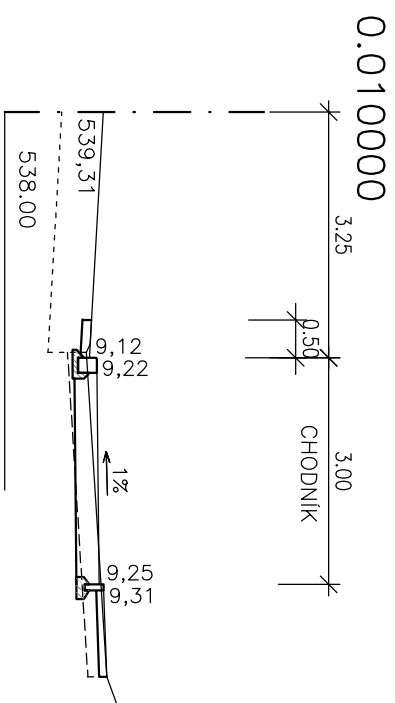
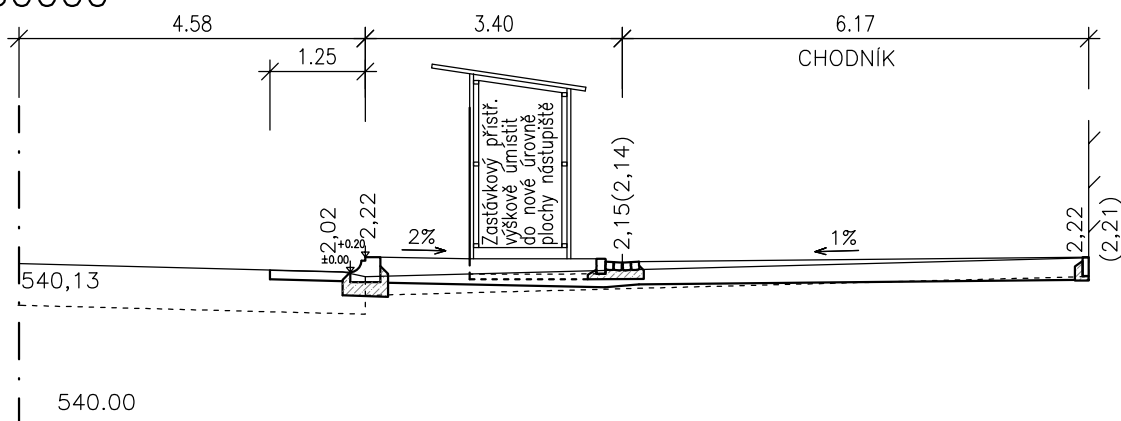

0.140000

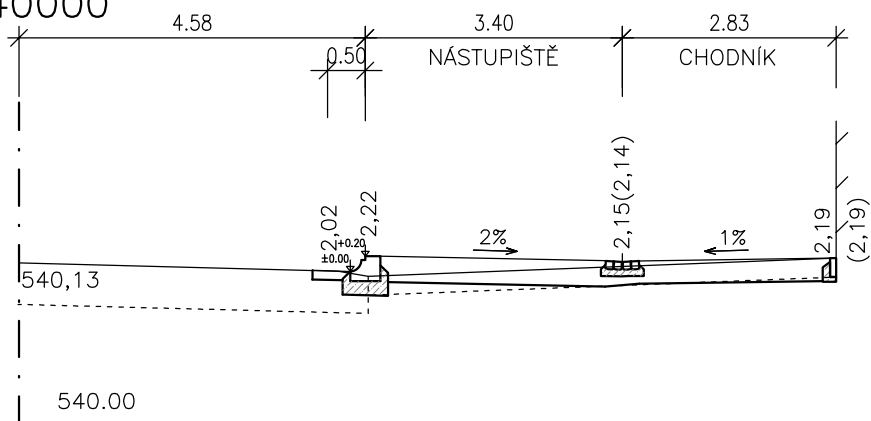

0.150000

